

## Programme of the day

Time	Plenary Session – Main Conference Room	Speaker
08:30	Coffee, Registration and Exhibitions	
09:00	Welcome and introduction Chairs opening remarks, aims of the day	Steve Statham: Chief Executive, St Luke's Hospice Plymouth
09:15	Compassionate Cities: A public health approach to end of life care	Professor Allan Kellehear: 50th Anniversary Professor (End-of-Life Care), University of Bradford
10:00	Key note speaker Questions & Answers session	
10:15	Strategic View from Plymouth City Council + Q&A	Carole Burgoyne: Strategic Director for People, Plymouth City Council
10:35	Compassionate networks - The Man in the Van (A personal story) + Q&A	Gail Wilson: Deputy Director of Clinical Services & Head of Education and Development, St Luke's Hospice Plymouth
10:55	Short video message	Right Honourable MP Johnny Mercer, Member of Parliament for Plymouth Moor View
	Chairs summary of the talks, introduction to afternoon	

11:00

**Main Foyer - Coffee & Exhibitions 11:00 – 11:20 (20 minutes)**

Time	Spotlight Session: From conversation to action, what have WE done? Main conference room	Speaker
11:20	Compassionate end of life care for the homeless	Gilly Barringer: Clinical Nurse Specialist, St Luke's Hospice Plymouth  Hazel Roberts: Clinical Manager in Harbour Drug and Alcohol Services, Livewell Southwest  Sean Mitchell: Support & Enterprise Manager, Bournemouth Churches Housing Association

PLYMOUTH, A  
COMPASSIONATE  
CITY - WHAT  
CAN YOU  
DO?

CONFERENCE 2018

EMPOWERING  
COMMUNITIES AND  
STRENGTHENING  
PARTNERSHIPS

THURSDAY 17 MAY 2018  
BORINGDON PARK  
GOLF CLUB, PL7 4QC  
8.30AM TO 5.00PM



Time	Spotlight Session: From conversation to action, what have WE done? Main conference room (continued)	Speaker
11:45	Compassionate Prisons	Martin Thomas: Community Specialist Nurse Team Lead, St Luke's Hospice Plymouth
12:10	Compassionate Friends	Paula Hine: Education and Development Manager, St Luke's Hospice Plymouth
12:25	Advance care planning initiative	Michael Thomas: End of Life/ Clinical Educator, St Luke's Hospice Plymouth
12:40	Chairs summary of the talks Panel Questions & Answers session Compassionate call to action: introduction to round robin sessions	

13:00	<b>Main Foyer – Lunch, Exhibitions &amp; Drumming workshop 13:00 – 14:00 (1hour)</b>
	Lorna Coulson "Celebrate your heartbeat. Celebrate you!"- Drumming Workshop Session A – 13:00 Session B – 13:30 Green room (join in on the day)

## Map of the conference

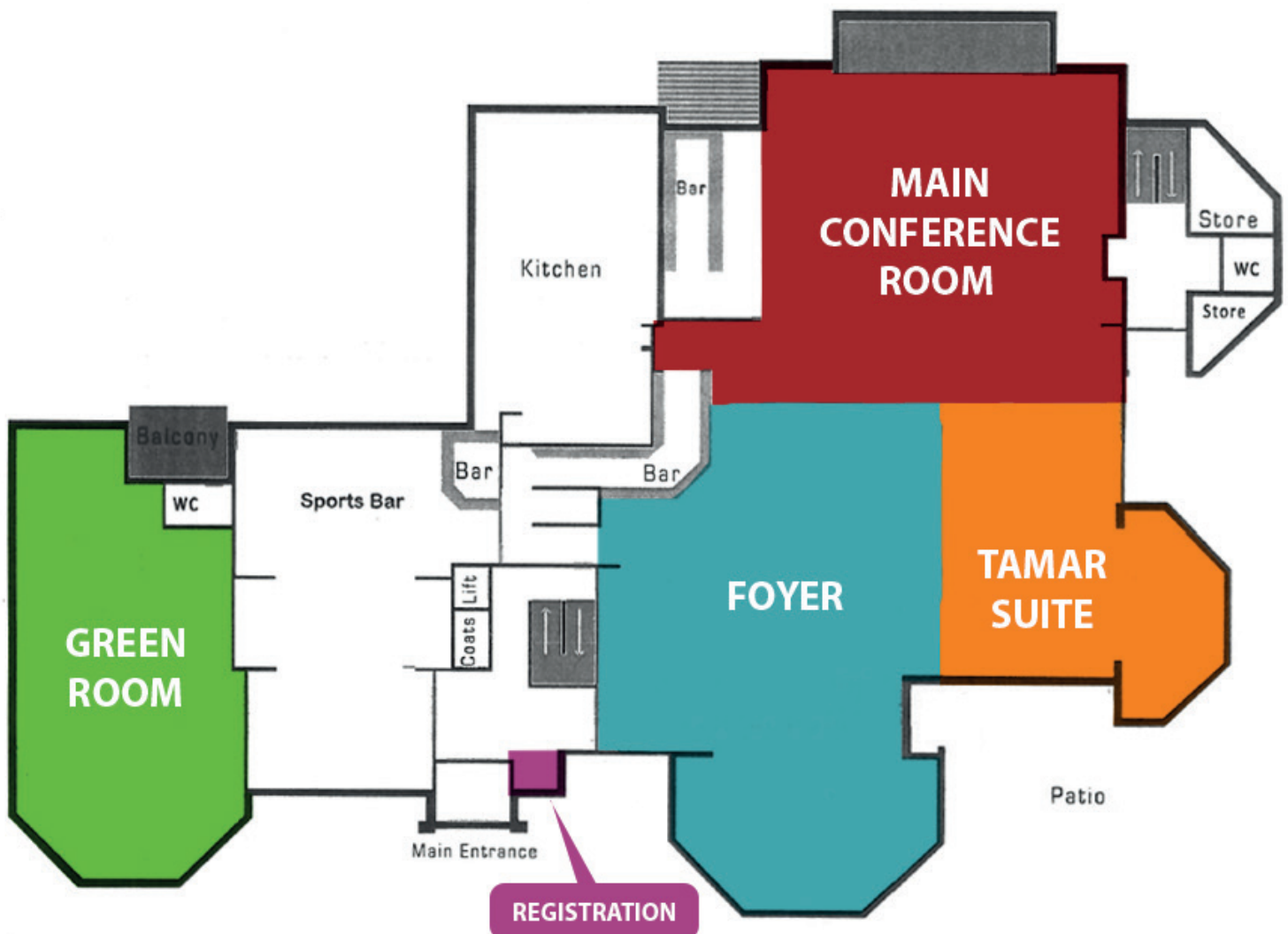

# Round Robin: Compassionate call to action

What can YOU DO to develop your compassionate community?

(Delegates will have selected 4 out of 12 sessions)

<b>14:00</b>	<b>Round robin sessions begin: Follow order on your individual name badge</b>
--------------	---

## Location of 20 minute Round Robins 14:00 – 15:30 (1 hour 30 minutes)

No.	Round Robin	Leading	Location
1	In schools, colleges & universities	Karen Thorrington Lisa Carter	Main conference room
2	In the workplace	Tracey Holman Warren Finney	Main conference room
3	In care homes	Shaen Milward Andrea Doherty	Main conference room
4	In city cafes and social spaces	Gail Wilson Kate Smith	Main conference room
5	To support bereavement	Jutta Widlake Michelle Kunz	Tamar Suite
6	To promote inclusion and address inequalities at end of life	Gilly Barringer Abenaa Assibey Dr Ben Jameson	Tamar Suite
7	In places of worship	Julie Theisinger Rev Chris Clewer	Tamar Suite
8	By raising awareness of end of life through art and exhibitions	Emma Millard Joanne Gray	Tamar Suite
9	By holding an annual peacetime memorial parade	Katie Rhodes Heather Sabel	The Foyer
10	By providing Compassionate Friends training	Paula Hine Mark Alderson	The Foyer
11	Identifying Compassionate Networks with eco-mapping	Sharon Smerdon Su Jameson	The Foyer
12	By ensuring compassionate care at end of life for those with dementia	Judith Tallbot Lorna Coulson	The Foyer

<b>15:30</b>	<b>Main Foyer – Comfort Break 15:30 – 15:50 (20 minutes)</b>
--------------	--

Time	Session Title - Main Conference Room	Speaker
15:50	Facilitator action plans	Round Robin facilitators
12:10	Chair's plenary and questions & answers / group feedback session	Steve Statham: Chief Executive, St Luke's Hospice Plymouth
12:25	Chairs closing remarks / Evaluations	



## Special thanks to everyone who contributed

